

# Biomass CHP local heating network

## Feuerstein paper factory, Traun (A)

### DETAILS & TECHNICAL INFORMATION

generating capacity: 15,000 kWth/1,600 kWel  
steam type: Live steam, 65 bar/480°C  
steam harnessing: 115,000 to/year, 4.5 bar pressure

fuel used: wood chips

### ADVICE & PROVISION OF SERVICES

supply of a new PM3 paper machine with steam from biomass and combined heat and power (CHP)

project development, implementation of the legal and permission planning, dynamic profitability calculation, drafting of the energy supplier and contractor contracts, consulting for CO2 certificate trading and additional saving potential

### PROJECT & DETAILS

investment costs: € 11.5 million  
planning time frame: 2002

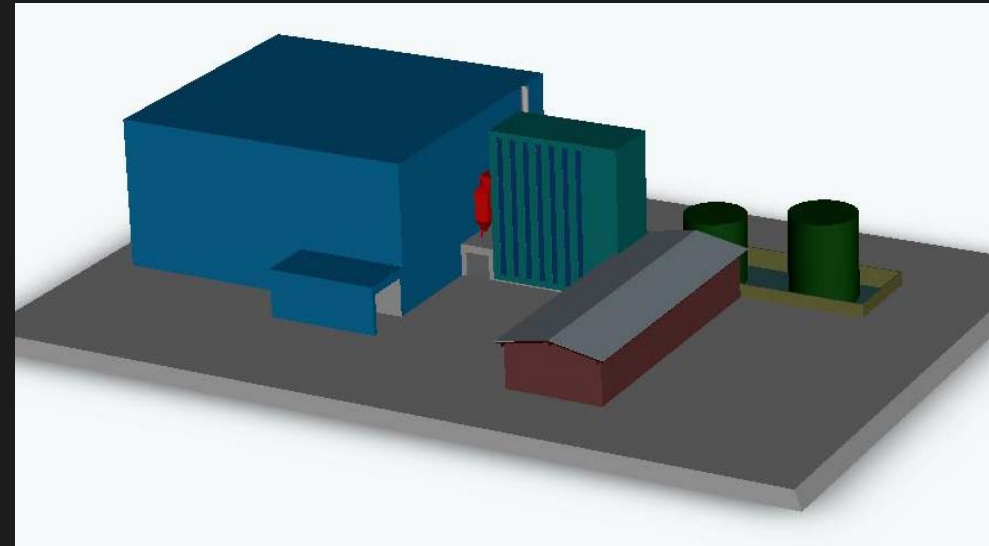

### MODULES & SERVICES

CONSULTING ⇒ EVALUATION ⇒ PRE-STUDY ⇒ ENGINEERING

⇒ CONTRACTING



**längle engineers**   
energy supply systems

ing. büro längle gmbh hauptstr.4 6840 götzis austria Tel: +43(0)5523 69194 office@energie-contracting.com www.energie-contracting.com